



250 Generation 3

FLEXIBLE COUPLING IDENTIFICATION CHART

MET-328 Open Spider Coupling with Aluminium Spacers (2023 ON)

This coupling uses aluminium extruded spacers, and doesn't require a sleeve. The front plate has twelve holes with two different size holes, and fits all spider couplings. The urethane inserts are blue.

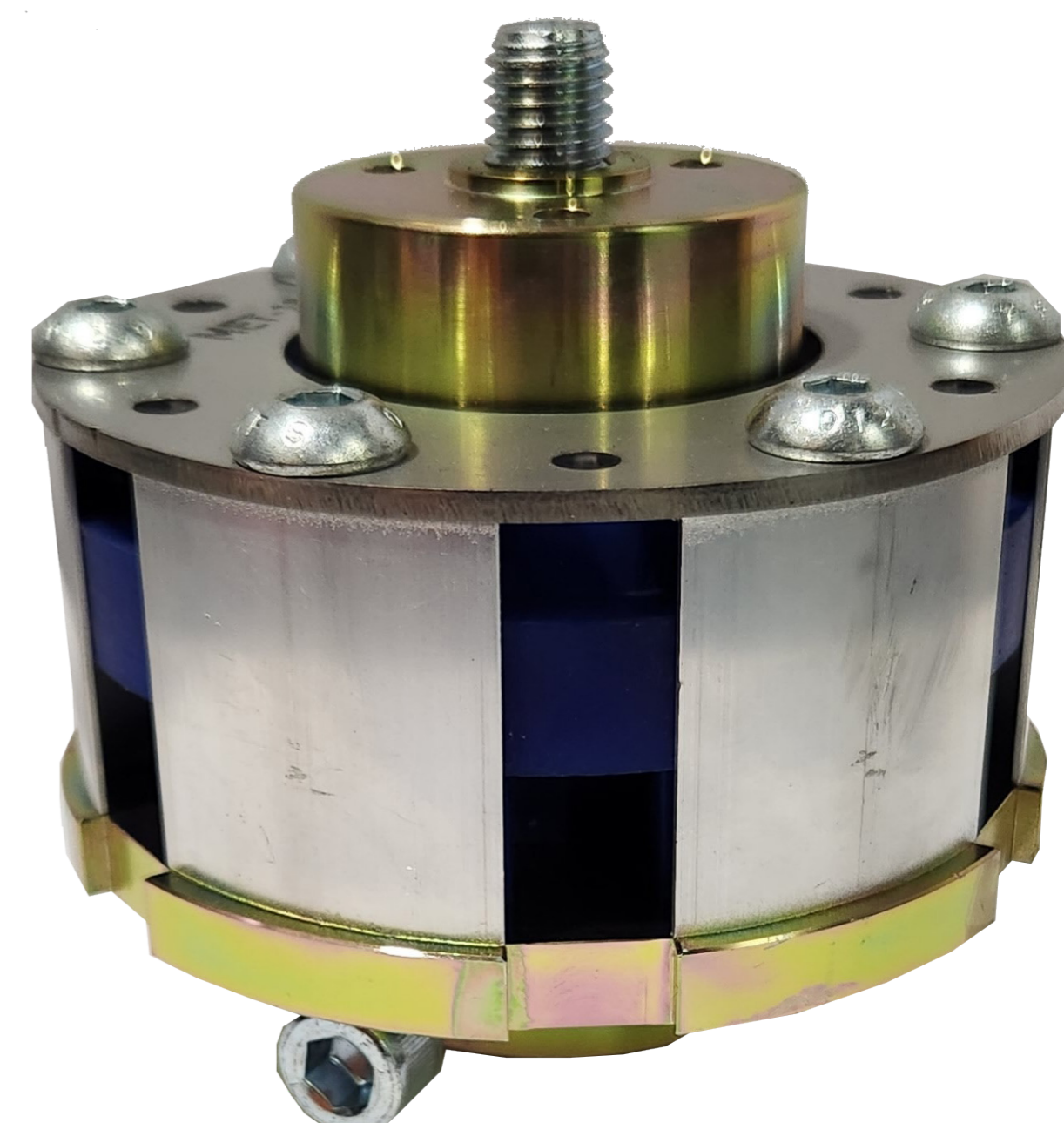

MET-328 Open Spider Coupling with Stainless Tube Spacers (2022 - 2023)

Stainless tube spacers are used on this coupling, and an outer sleeve is needed (not shown). The front plate has 6 holes and is etched MET-100.

MET-028 Cast Spider Coupling (2015 - 2022)

This coupling has a cast single piece cast housing and the cover plate has lugs. The urethane inserts are usually yellow, and the front insert could be positioned in two ways.



MET-25228 Red Cast Urethane Coupling (2008 - 2015)

This non serviceable coupling was also cast in black.

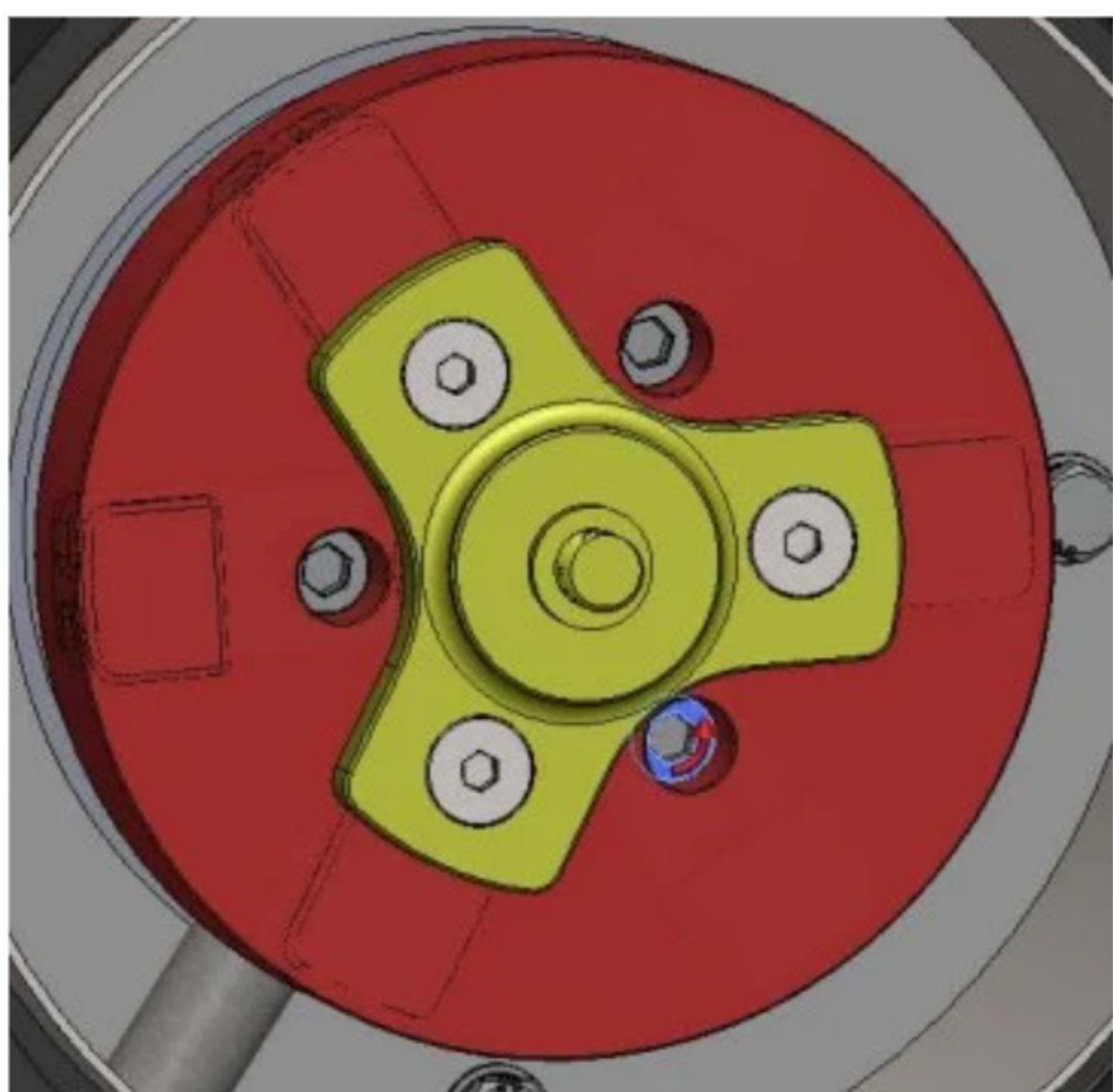

SCAN HERE TO GO TO FLOOREX MANUALS



FLOOREX[®]
PRODUCTS

Australia-Wide - 1800 356 673

www.floorex.com.au